

Locating and Using LinkedIn Learning in SuccessFactors

All Wellstar employees now have access to on-demand, online training from LinkedIn Learning. **LinkedIn Learning runs on Chrome only!**

To Locate LinkedIn Learning Courses in SuccessFactors

1. In the **Find Learning** box, select **Browse all courses>**.
2. **Over 8,000 LinkedIn Learning courses are listed in SuccessFactors.** There are two ways to locate courses:
 - a. **By Topic:** Type the topic in the search box and press Enter.
 - b. **By LinkedIn Learning content:** Select **Source** and select **LinkedIn Learning** and Enter.

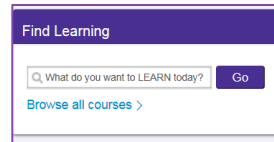

Find Learning

What do you want to LEARN today?

[Browse all courses >](#)

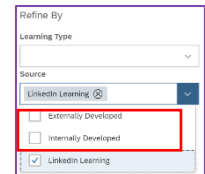

Refine By

Learning Type

Source

☐ Externally Developed

☐ Internally Developed

☒ LinkedIn Learning

To Watch LinkedIn Learning Courses

1. Select the title to learn more about the course. From there, you can **Assign to Me** for later or begin the course by selecting **Start Course**, or...
2. Select **Start Course** to begin the course from this view.
3. Either technique will result in the course showing as complete in your SuccessFactors records.
4. You can also go straight to LinkedIn Learning from the internet and log in (see [Logging in to LinkedIn Learning](#)).

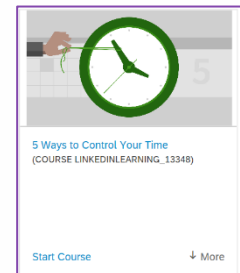

To Activate LinkedIn Learning the First Time

During the activation process, you will have the option to connect a LinkedIn account to your LinkedIn Learning account. If they do not have a LinkedIn account, you will be able to create one. The benefits of connecting a LinkedIn account include:

- A more personalized learning experience that includes special course recommendations for you based on job title, skills, and industry.
- Discoverable and relevant learning content within the LinkedIn.com experience (e.g., in the feed) to keep learning top of mind and easy to access.

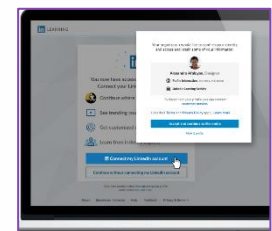

To Login from LinkedIn Learning

1. From <https://www.linkedin.com/learning/>, Sign In with your **WellStar email**.
2. If you have previously registered your LinkedIn account with LinkedIn Learning, you may need to enter your **personal LinkedIn account password**.
3. Select **Sign in with Single Sign-On**. See [Logging in to LinkedIn Learning](#)

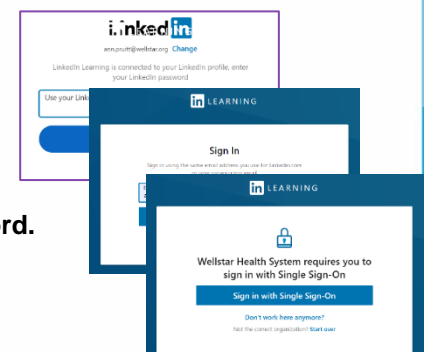

To Locate Collections by Topics

From within LinkedIn Learning, select **Browse**, then **Wellstar Health System**. Scroll down to **Collections from Wellstar Health System**.

Helpful Links

[Get to Know LinkedIn Learning](#)

For questions, contact lead@wellstar.org

